

TABLA DE AREAS	
AREAS SEGUN DATOS ESCRITURAS	
SOLAR No.	AREA SOLAR
No.-1	2,999.85 MC
No.-2	3,139.81 MC
No.-3	390.59 MC
No.-4	374.82 MC
No.-5	363.87 MC
No.-6	97.18 MC
No.-7	5,107.99 MC
No.-1A	4,627.25 MC **
No.-2A	835.69 MC
No.-3A	1,340.15 MC
No.-4A	524.34 MC **
No.-5A	3,657.90 MC
SOLAR TOTAL	23,459.44 MC

** SERVIDUMBRE DE PASO DE 442.33 MC RESTADA

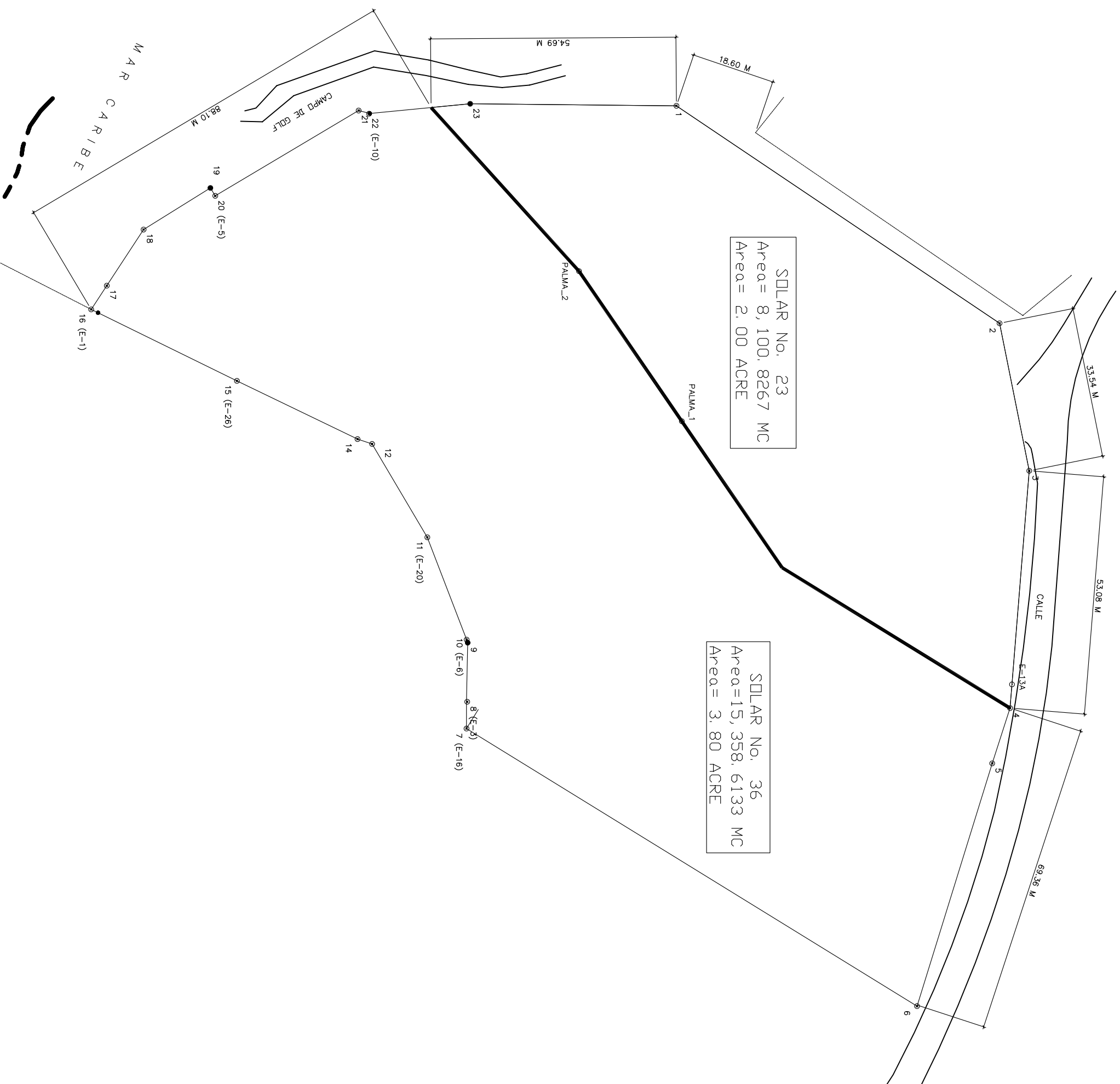

THIS DRAWING AND ITS CONTENTS IS THE PROPERTY OF THE OFFICES OF ESTANCIAS REALES S. E. AND SHALL BE USED AS A REFERENCE DOCUMENT AND WORKING INSTRUMENT ONLY BY AUTHORIZED PERSONNEL. ANY PARTIAL OR TOTAL REPRODUCTION OR USE OF SAID DOCUMENT OR THE INFORMATION CONTAINED THEREIN IS STRICTLY PROHIBITED WITHOUT THE APPROPRIATED WRITTEN CONSENT AND SHALL BE RETURNED TO ITS OWNERS IF REQUESTED. ©

LA ROMANA
REPUBLICA DOMINICANA

TITLE
AREAS DE SOLARES CACIQUE 23 & CACIQUE 36

NO.	DATE	BY

DESIGNED: MAYO 2008
DRAWING SCALE: 1:1,000
SHEET NO. OF